

Wouss

Lighting Emotion



Annecy Bollard



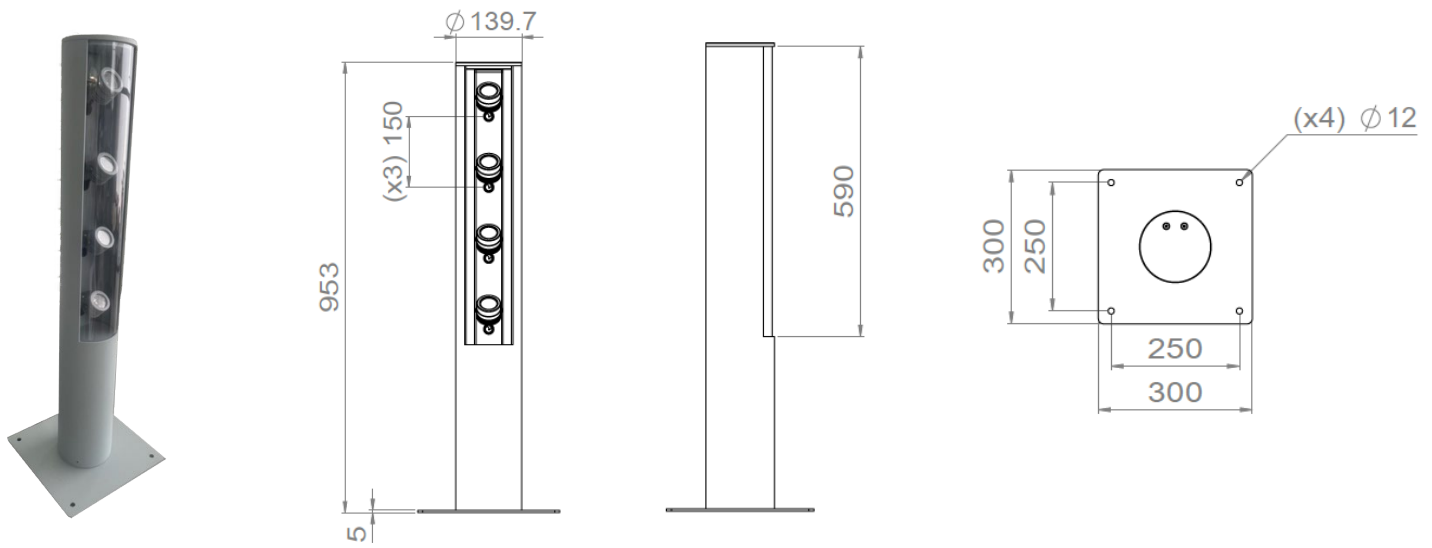

Annecy Bollard

Range	Outdoor accent lighting pillar
Description	Stainless steel bollard with 4 vertically adjustable spotlights Grey finish RAL 9006 (other upon request)
Net weight	22 kg
LED characteristics	2200K – 2700K - 3000K – 4000K – 5000K – 6500K or mix colours
Optical beam	6° - 10°-15° - 35° (other upon request)
Connection	Delivered with 1m standard cable (other length upon request)
Integrated power supply	230V on/off or dimmable driver upon request
LED power	16W at 350mA max
Use limitations	The product must be installed into a ventilated area. Any use with an ambient temperature higher than the specified ambient temperature (Ta) would lead to a more rapid mortality of the product and the withdrawal of our guarantees. The drivers, if not delivered by LOuss, must be approved before use.
Warranty	Life span: L80B10 at 50,000 hours (80% remaining flux) at 25°C ambient temperature. 3-year parts and labour warranty. The warranty does not apply to products that have been opened, modified or repaired and does not cover the effects of a wrong connection, careless, abusive handling, overvoltage, lighting injury, as well as the normal wear of the product. All products are electrically tested and received a functional burn-in.

All the connections have to be made before powering up,
otherwise the luminaires could be seriously damaged.

LOuss

Last update : 21/07/2022

2/4

Firalux & LOuss brands

SARL, Capital 40 000€
RCS DIJON B 503 367 245
TVA/VAT n°: FR24 503 367 245
APE 4676Z

Tel. : +33 380 48 65 68
contact@louss.fr
www.louss.fr
Best group

Siège social / Head Office
PA Les Terres d'Or
Route de Saint Philibert
21220 Gevrey Chambertin - FRANCE



Ancey Bollard Installation's instructions

1

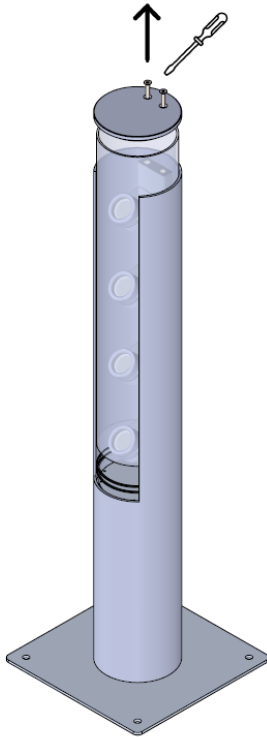

2

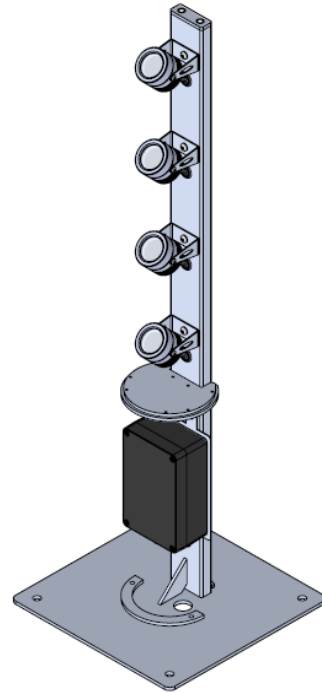

3

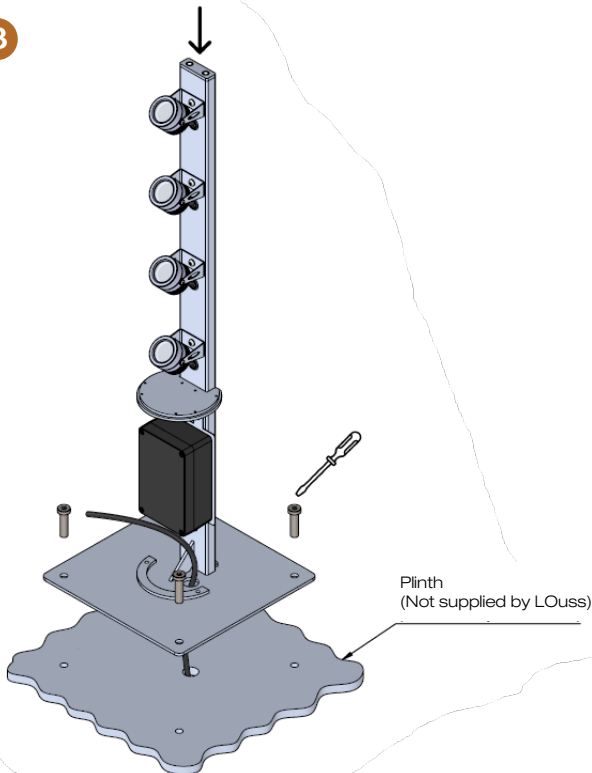

4

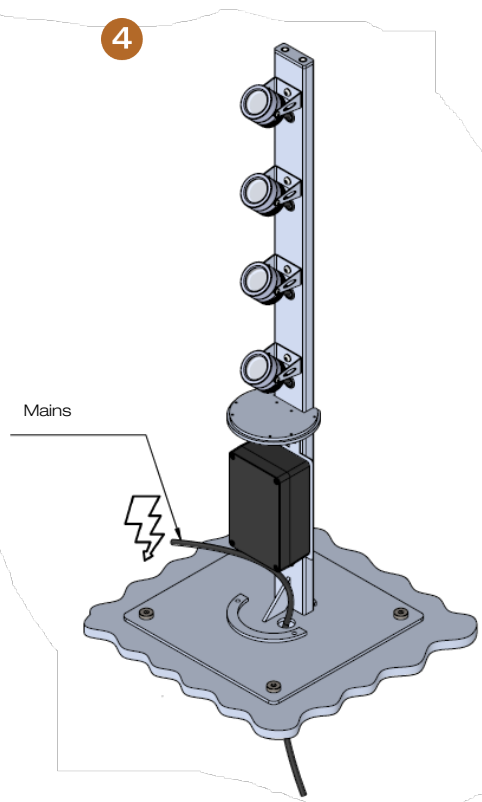

All the connections have to be made before powering up,
otherwise the luminaires could be seriously damaged.



Annecy Bollard Installation's instructions

5

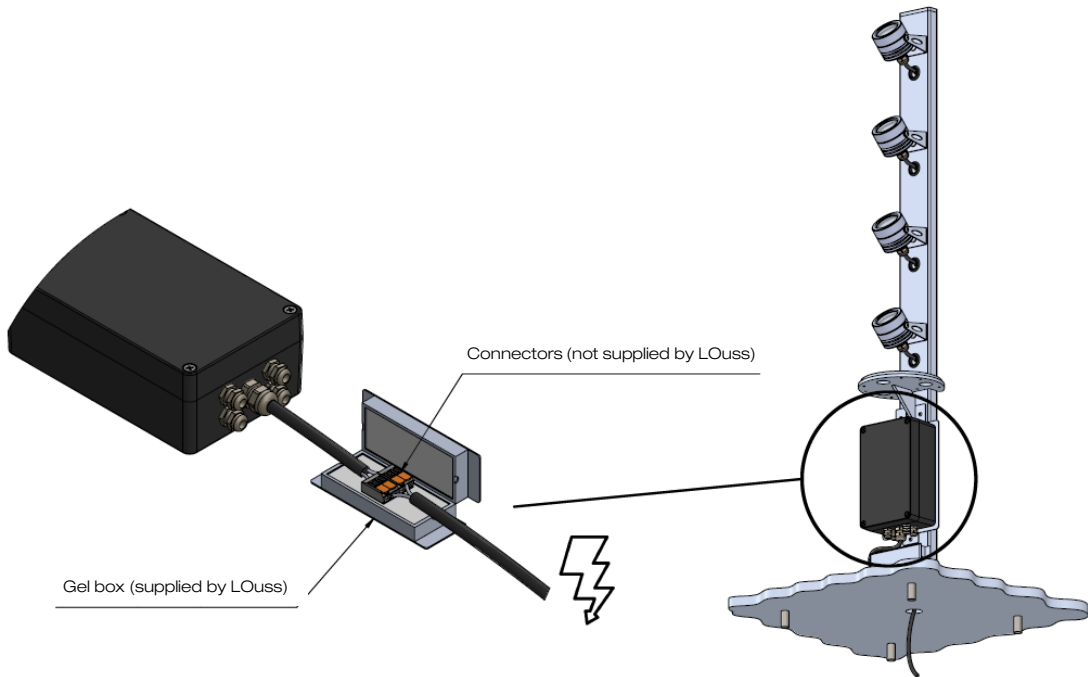

6

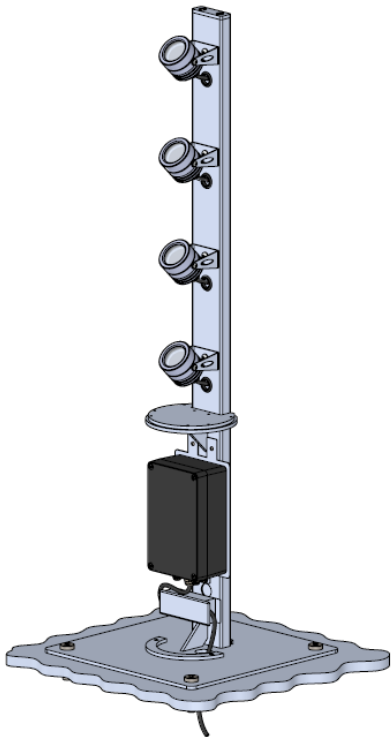

7

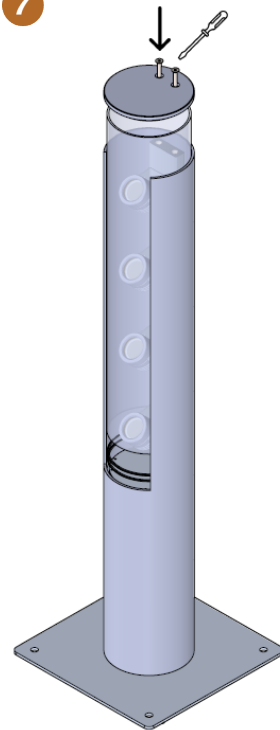

All the connections have to be made before powering up,
otherwise the luminaires could be seriously damaged.