

Wouss

Lighting Emotion

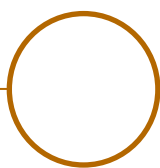

SCOPIO

The spotlight specially
developed for museums



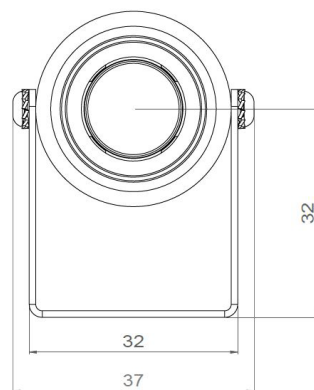
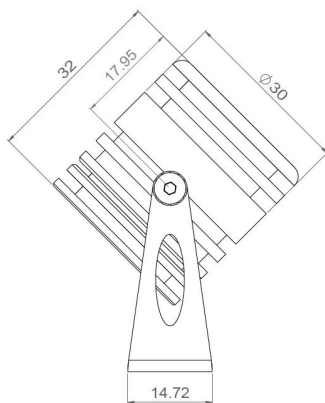

SCOPIO

Range	Luminaire for accent lighting
Description	Natural anodized aluminum body Stainless steel bracket
Dimensions	Spotlight diameter : 30mm Spotlight length : 32mm Bracket length : 32mm Bracket width : 14.72mm
Net weight	0.068 kg
LED characteristics	1 LED : 3000K – 4000K (other upon request)
Optical beam	15° - 30° - 40° - 60° (other upon request)
Connection	Supplied with 0.5m standard cable (more length upon request) Individual connection or connection in series on external constant current driver
Separate power supply	700mA max. external constant current driver Dimmable driver upon request For the US & Canada use a UL class 2 driver
LED power	2.4W at 700mA max.
Use limitations	The product must be installed into a ventilated area Any use with an ambient temperature higher than the specified ambient temperature (Ta) would lead to a more rapid mortality of the product and the withdrawal of our guarantees The drivers, if not delivered by LOuss, must be approved before use
Warranty	Life span: L80B10 at 50,000 hours (80% remaining flux) at 25°C ambient temperature. 3-year parts and labour warranty The warranty does not apply to products that have been opened, modified or repaired and does not cover the effects of a wrong connection, careless, abusive handling, overvoltage, lighting injury, as well as the normal wear of the product All products are electrically tested and received a functional burn-in

All the connections have to be made before powering up,
otherwise the luminaires could be seriously damaged.

LOuss

Last update : 2025.07.11

2/2

BEST SAS, Capital 200 000€
RCS Dijon B 408 483 485
TVA/VAT n° : FR94 408 483 485
APE 2612Z

Tel. : +33 380 48 65 68
contact@louss.fr
www.louss.fr
Best & LOuss

Siège social / Head Office
PA Les Terres d'Or
Route de Saint Philibert
21220 Gevrey Chambertin - FRANCE