

## AURORE D55 WALL-MOUNTED



## AURORE D55 ROUND WALL-MOUNTED

<b>Range</b>	Highly adjustable luminaires for general & accent lighting
<b>Description</b>	Luminaire equipped with low luminance spotlight Rotation 360° - Adjustable tilt 90° max Easily changeable LED, optics and accessories on-site without any tool, with integrated <b>Permuto</b> Easy Swap system (see page 4)
<b>Finish</b>	Black RAL 9005 matt finish White RAL 9003 matt finish (other upon request)
<b>Dimensions</b>	Spotlight diameter : 55mm Spotlight length : 95mm Wall-mounted box diameter : 52mm
<b>Net weight</b>	0.350kg
<b>LED characteristics</b>	2700K - 3000K – 3500K – 4000K – 5000K (other upon request) MacAdam ellipse : 3 SDCM (standard) – 2 SDCM (premium) CRI90 (standard version) – CRI95, R9 > 80
<b>Optical beams</b>	13° - 18° - 24° -32° (CRI < 98) 7° (IRC 90) UGR < 15
<b>Accessories</b>	Filters, honeycomb grids upon request
<b>Luminous flux</b>	600 to 2,000 lumen according to version
<b>Connection</b>	Supplied with 0.5m cable Or connectors in the box
<b>Power supply</b>	Remote constant current driver 1400mA max. according to version Dimmable driver upon request For US & Canada, use a UL class 2 driver
<b>Power</b>	6W to 25W according to version
<b>Use limitations</b>	The product must be installed into a ventilated area Any use with an ambient temperature higher than the specified ambient temperature (Ta) would lead to a more rapid mortality of the product and the withdrawal of our guarantees The drivers, if not delivered by LOuss, must be approved before use
<b>Warranty</b>	Life span: L80B10 at 50,000 hours (80% remaining flux) at 25°C ambient temperature. 3-year parts and labour warranty The warranty does not apply to products that have been opened, modified or repaired and does not cover the effects of a wrong connection, careless, abusive handling, overvoltage, lighting injury, as well as the normal wear of the product All products are electrically tested and received a functional burn-in

All the connections have to be made before powering up,  
otherwise the luminaires could be seriously damaged

LOuss

Last update: 2025.06.13

2/4

BEST SAS, Capital 200 000€  
RCS Dijon B 408 483 485  
TVA/VAT n° : FR94 408 483 485  
APE 2612Z

Tel. : +33 380 48 65 68  
contact@louss.fr  
[www.louss.fr](http://www.louss.fr)  
Best & LOuss

Siège social / Head Office  
PA Les Terres d'Or  
Route de Saint Philibert  
21220 Gevrey Chambertin - FRANCE



## AURORE D55 ROUND WALL-MOUNTED

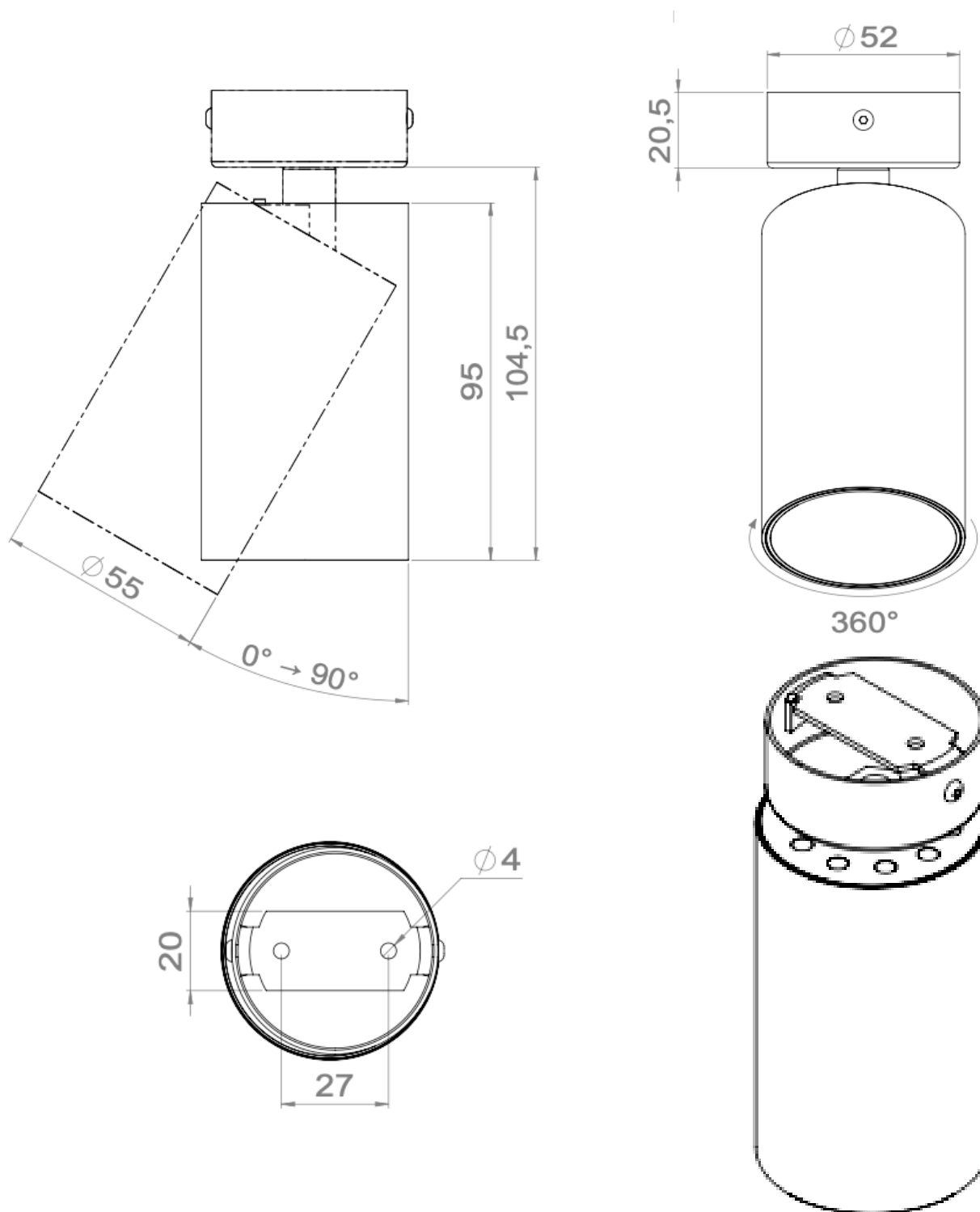

All the connections have to be made before powering up,  
otherwise the luminaires could be seriously damaged

**LOUSS**

Last update: 2025.06.13

3/4

BEST SAS, Capital 200 000€  
RCS Dijon B 408 483 485  
TVA/VAT n° : FR94 408 483 485  
APE 2612Z

Tel. : +33 380 48 65 68  
contact@louss.fr  
[www.louss.fr](http://www.louss.fr)  
Best & LOUSS

Siège social / Head Office  
PA Les Terres d'Or  
Route de Saint Philibert  
21220 Gevrey Chambertin - FRANCE



## AURORE D55 ROUND WALL-MOUNTED



L'Ouss **Permuto** – easy swap system



All the connections have to be made before powering up,  
otherwise the luminaires could be seriously damaged

L'Ouss

Last update: 2025.06.13

4/4

BEST SAS, Capital 200 000€  
RCS Dijon B 408 483 485  
TVA/VAT n° : FR94 408 483 485  
APE 2612Z

Tel. : +33 380 48 65 68  
contact@louss.fr  
[www.louss.fr](http://www.louss.fr)  
Best & L'Ouss

Siège social / Head Office  
PA Les Terres d'Or  
Route de Saint Philibert  
21220 Gevrey Chambertin - FRANCE