

LOUSS

Lighting Emotion

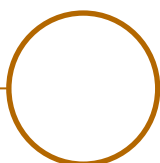
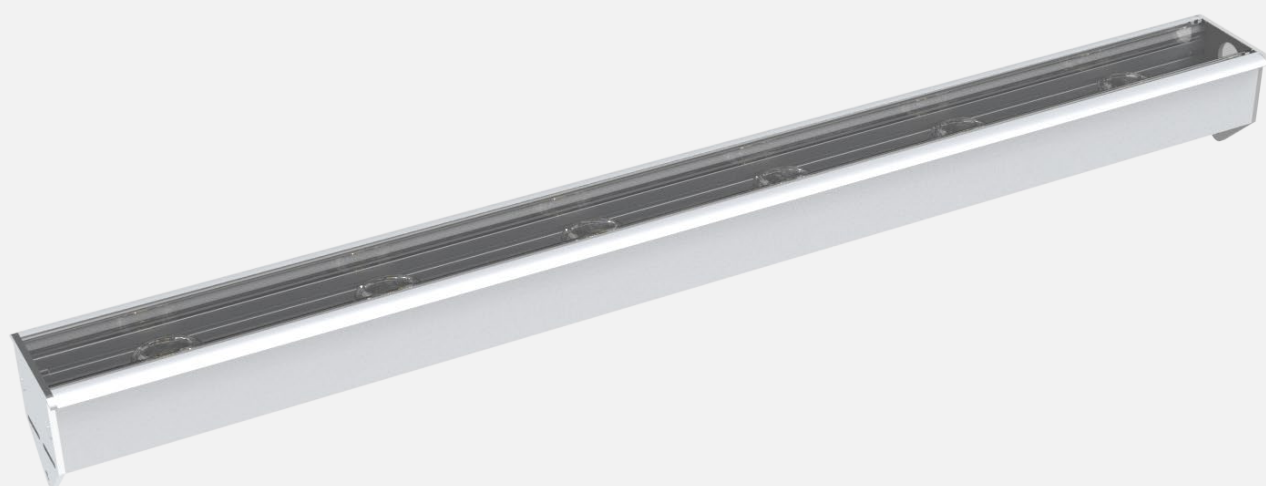

STIC

The colourful linear LED light



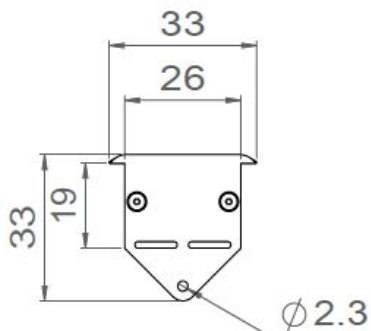

Standard end caps

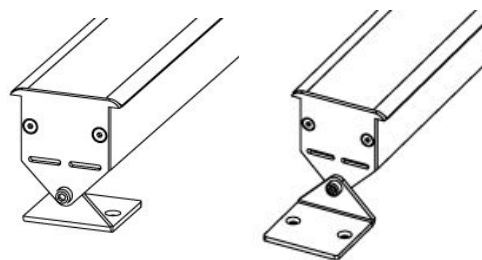

Optional : Foldable fixing end caps or adjustable fixing brackets

STIC

Range	Indoor linear LED light
Description	Natural anodised aluminium profile PMMA diffuser: opal, satin-like or transparent Optional : Foldable fixing end caps or adjustable fixing brackets
Dimensions	Profile : 33x21mm Lengths : 330 or 385mm – 450 ou 480mm – 650 mm – 760mm – 970mm – 1135mm
LED characteristics (LED engine)	6 LED (330mm / 385mm TW) : 3000K – 4000K – RGBW – RGB 12 LED (450mm / 650mm / 760mm TW) : 3000K – 4000K – RGBW – RGB 18 LED (970mm / 1135mm TW) : 3000K – 4000K – RGBW – RGB 24 LED (1310mm / 1475mm TW) : 3000K – 4000K – RGBW – RGB Monochrome or RGB LED strip or LED engine
Optical beam	LED engine : 14° - 30° - 40° - 60° - Elliptical (other LED beams upon request) + diffuser LED strip : Diffuser
Connection	Delivered with 1m standard cable (more length upon request)
Separate power supply	350mA – 500mA
LED power	350mA (LED engine) : 7.2W (6 LED) – 14.4W (12 LED) – 21.6W (18 LED PCB) 500mA (LED engine) : 10.8W (6 LED) – 21.6W (12 LED) – 32.4W (18 LED) 24V (LED strip) : Power according to LED strip used
Use limitations	The product must be installed into a ventilated area Any use with an ambient temperature higher than the specified ambient temperature (Ta) would lead to a more rapid mortality of the product and the withdrawal of our guarantees The drivers, if not delivered by LOuss, must be approved before use
Warranty	Life span: L80B10 at 50,000 hours (80% remaining flux) at 25°C ambient temperature 3-year parts and labour warranty The warranty does not apply to products that have been opened, modified or repaired and does not cover the effects of a wrong connection, careless, abusive handling, overvoltage, lighting injury, as well as the normal wear of the product All products are electrically tested and received a functional burn-in

All the connections have to be made before powering up, otherwise the luminaire could be seriously damaged.

LOuss

Creation : 2018.09.20 / Last update : 2022.11.16

2/4

BEST SAS, Capital 200 000€
RCS Dijon B 408 483 485
TVA/VAT n° : FR94 408 483 485
APE 2612Z

Tel. : +33 380 48 65 68
contact@louss.fr
www.louss.fr
Best & LOuss

Siège social / Head Office
PA Les Terres d'Or
Route de Saint Philibert
21220 Gevrey Chambertin - FRANCE



STIC Dimensions

6 LEDs

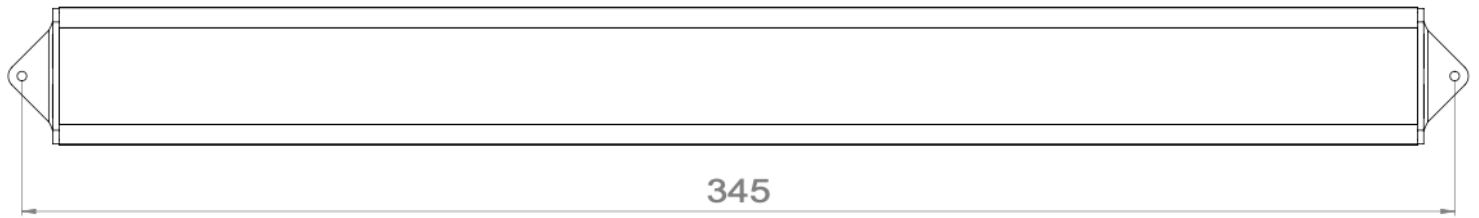
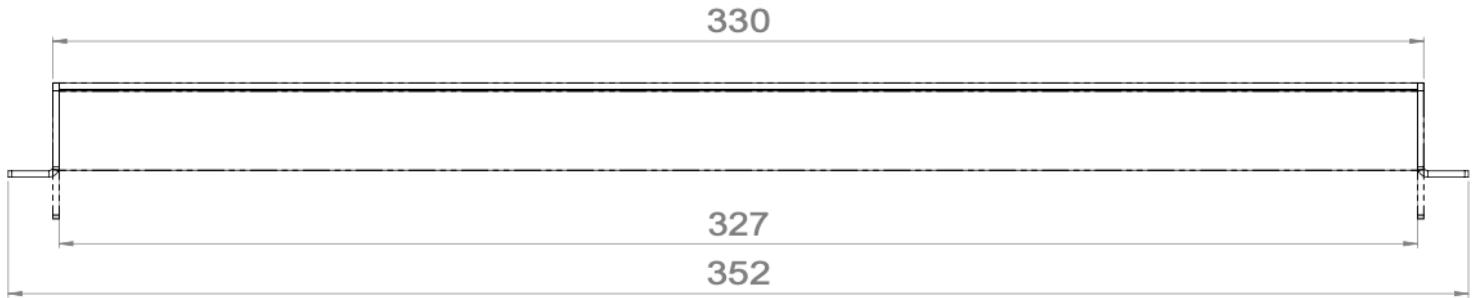

12 LEDs

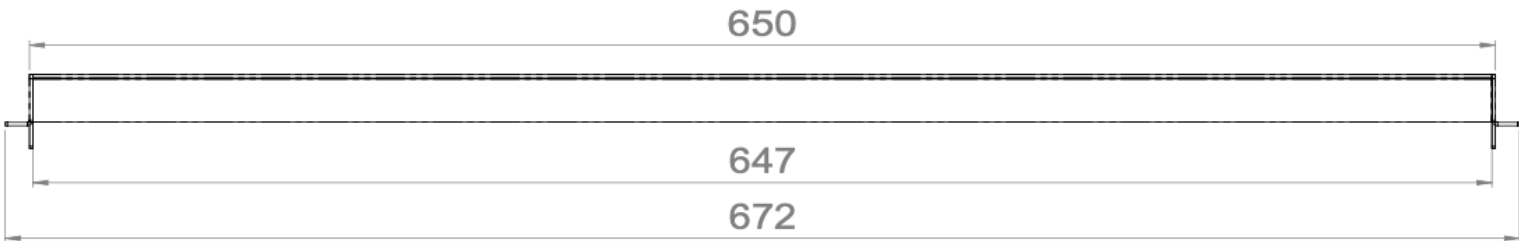

All the connections have to be made before powering up,
otherwise the luminaire could be seriously damaged.

LOUSS

BEST SAS, Capital 200 000€
RCS Dijon B 408 483 485
TVA/VAT n° : FR94 408 483 485
APE 2612Z

Creation : 2018.09.20 / Last update : 2022.11.16

Tel. : +33 380 48 65 68
contact@louss.fr
www.louss.fr
Best & LOUSS

Siège social / Head Office
PA Les Terres d'Or
Route de Saint Philibert
21220 Gevrey Chambertin - FRANCE

3/4



STIC Dimensions

18 LEDs

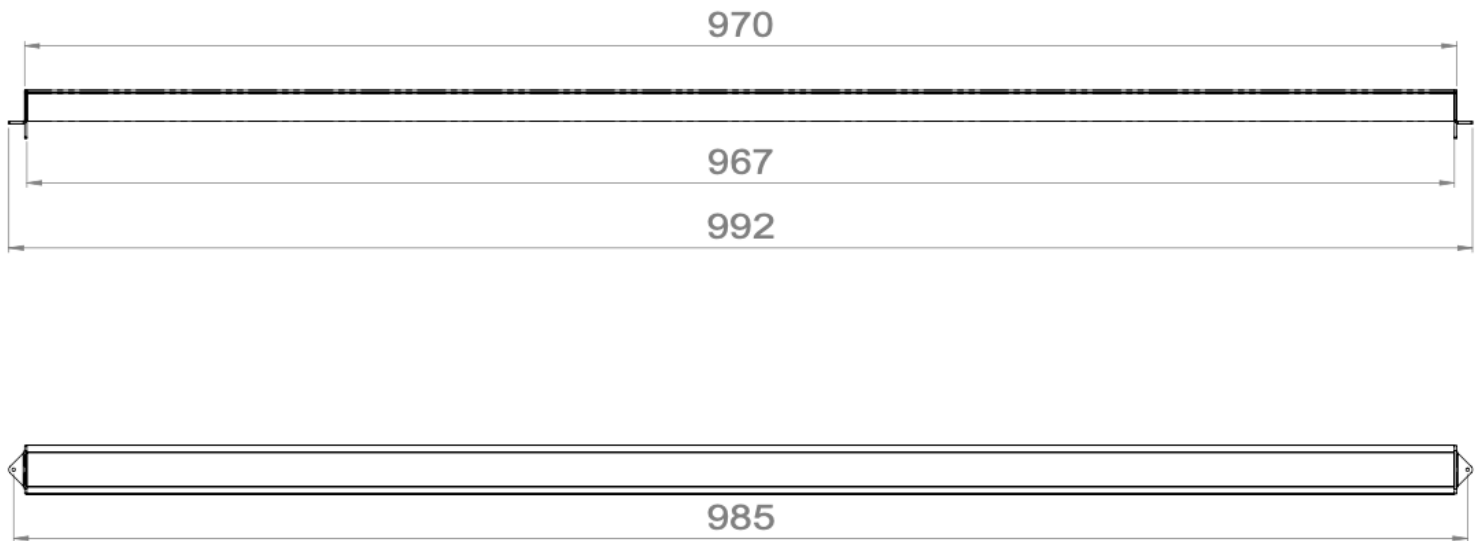

24 LEDs

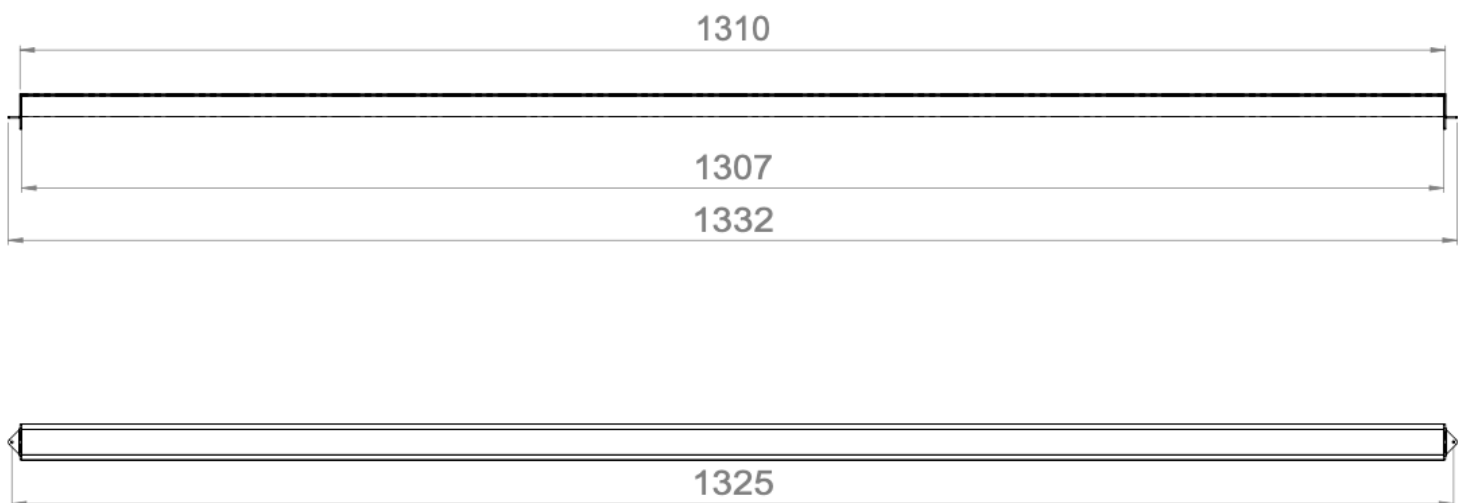

All the connections have to be made before powering up,
otherwise the luminaire could be seriously damaged.

LOUSS

BEST SAS, Capital 200 000€
RCS Dijon B 408 483 485
TVA/VAT n° : FR94 408 483 485
APE 2612Z

Creation : 2018.09.20 / Last update : 2022.11.16

Tel. : +33 380 48 65 68
contact@louss.fr
www.louss.fr
Best & LOUSS

Siège social / Head Office
PA Les Terres d'Or
Route de Saint Philibert
21220 Gevrey Chambertin - FRANCE

4/4